

Inclusive Education

AAC App Set up for Touch Chat

iPads should initially be locked into Landscape orientation

How:

- Draw down from top right corner to access the control panel, press on the lock once you have it in the landscape orientation.

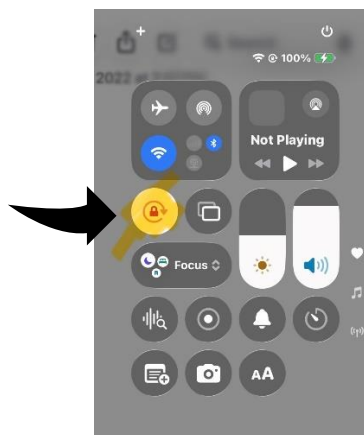

When starting with a brand-new Vocabulary:

- To choose a new Vocabulary, go to the Vocab section located at the top left corner of the page then decided which WORD POWER vocabulary file to use (typically this is WordPower60SS)
- Customize this vocabulary and rename it 0 – the student's first name and then last name Initial – Month2025 (e.g. **0 - KrisM – Dec2025**)

Touch Chat Settings (accessed through the Menu in the app):

Done	Settings	Done	Settings	Options for Voices:
	Profiles Save Profile > Load Profile > Navigation Page Animation <input type="checkbox"/> Allow Gestures <input checked="" type="checkbox"/> Gesture Pop Sound <input type="checkbox"/> Button Click Sound <input type="checkbox"/> Button Navigation Icons <input type="checkbox"/> Page Size Status Bar <input checked="" type="checkbox"/> Keyguard Inset Off >		Editing Menu Passcode <input type="text"/> Use Menu Passcode <input type="checkbox"/> Editing Note Editing Note: Menus may be completely disabled in the Apps section of the iOS Settings. (Allow Editing) Allow Vocabulary Deletion <input checked="" type="checkbox"/> Speech English voice Melany > French (Canada) voice Amélie > Phone/FaceTime Voice Samantha > Novelty Voices <input checked="" type="checkbox"/> Speech Display Bar	<ul style="list-style-type: none"> • Julian (boy) • Victoria (girl) • Melanie (woman) • Elijah (teen male) US

<div> <div>Done</div> <div>Settings</div> </div> <div>Speech Display Bar</div> <div>Hide Speech Display <input type="checkbox"/></div> <div>Allow Copy/Paste <input checked="" type="checkbox"/></div> <div>Auto Capitalization <input checked="" type="checkbox"/></div> <div>Show Icons <input type="checkbox"/></div> <div>Hide Delete Button <input type="checkbox"/></div> <div>Font Arial ></div> <div>Font Size 50 Point ></div> <div>Font Color Black ></div> <div>Background Color White ></div> <div>Number of Lines 1 Line ></div> <div>Visible Cursor <input type="checkbox"/></div>	<div> <div>Done</div> <div>Settings</div> </div> <div>Speech Display Bar</div> <div>Number of Lines 1 Line ></div> <div>Visible Cursor <input type="checkbox"/></div> <div>Allow Place Cursor <input checked="" type="checkbox"/></div> <div>Tap Action Speak ></div> <div>Highlight Spoken Word OFF ></div> <div>Highlight Color Phone/FaceTime - ></div> <div>Expanded Speech Area</div> <div>Font Arial ></div> <div>Font Size 80 Point ></div> <div>Font Color Black ></div> <div>Background Color White ></div>	<div> <div>Done</div> <div>Settings</div> </div> <div>Speak</div> <div>Speak Characters <input type="checkbox"/></div> <div>Speak Words <input checked="" type="checkbox"/></div> <div>Speak Sentences <input checked="" type="checkbox"/></div> <div>Auto Clear Off ></div> <div>Grammar <input checked="" type="checkbox"/></div> <div>Prevent Interruption <input checked="" type="checkbox"/></div> <div>Data Logging</div> <div>Enable Logging <input type="checkbox"/></div> <div>Privacy Password</div> <div>Realize Language™ Setup ></div> <div>Buttons</div> <div>Activate on Release <input type="checkbox"/></div>
<div> <div>Done</div> <div>Settings</div> </div> <div>Buttons</div> <div>Activate on Release <input type="checkbox"/></div> <div>Dwell Time None ></div> <div>Release Time None ></div> <div>Force Font Size <input type="checkbox"/></div> <div>Highlight Touch <input checked="" type="checkbox"/></div> <div>Gradient Fill <input checked="" type="checkbox"/></div> <div>Gradient Saturation <input type="range" value="0"/></div> <div>Hide All Icons <input type="checkbox"/></div> <div>Show Hidden Buttons <input type="checkbox"/></div> <div>Show grid <input checked="" type="checkbox"/></div> <div>Dynamic Grammar Labels <input type="checkbox"/></div> <div>Button Margin 5 Point ></div>	<div> <div>Done</div> <div>Settings</div> </div> <div>Prediction</div> <div>Prediction Type Learning + Static ></div> <div>Learned Words ></div> <div>Whiteboard</div> <div>Disable drawing in split view <input type="checkbox"/></div> <div>Scale drawing in split view <input type="checkbox"/></div> <div>Reload last drawing <input type="checkbox"/></div> <div>Autosave drawing <input type="checkbox"/></div> <div>Head Tracking</div> <div>Enable Head Tracking <input type="checkbox"/></div> <div>Social Networking</div> <div>Allow Social Networking <input checked="" type="checkbox"/></div> <div>Amp Connect</div> <div>Select Amp Not Connected ></div>	